



Proposal Submitted By:
 Contractor's Name
 Contractor's Address City State Zip Code

STATE OF ILLINOIS
 Local Public Agency County Section Number
 Street Name/Road Name Type of Funds

Material proposal Deliver and Install Proposal Plans

For a County and Road District Project
 Submitted/Approved
 Highway Commissioner Signature & Date
 Submitted/Approved
 County Engineer/Superintendent of Highways Signature & Date

For a Municipal Project
 Submitted/Approved/Passed
 Signature & Date
 Official Title

Department of Transportation
 Released for bid based on limited review
 Regional Engineer Signature & Date
AGREEMENT OF UNDERSTANDING 1/4/24

Note: All proposal documents, including Proposal Guaranty Checks or Proposal Bid Bonds, should be stapled together to prevent loss when bids are processed.

Local Public Agency

County

Section Number

[Empty box for Local Public Agency]

Menard

24-00000-00-GM

NOTICE TO BIDDERS

Sealed proposals for the project described below will be received at the office of Menard County Highway Department

15620 Chautauqua Road, Petersburg, IL 62675

Name of Office
until 10:00 AM on 02/22/24
Time Date

1. Plans and proposal forms will be available in the office of

Menard County Highway Department, 15620 Chautauqua Road, Petersburg, IL 62675

2. Prequalification

If checked, the 2 low bidders must file within 24 hours after the letting an "Affidavit of Availability" (Form BC 57) in duplicate, showing all uncompleted contracts awarded to them and all low bids pending award for Federal, State, County, Municipal and private work. One original shall be filed with the Awarding Authority and one original with the IDOT District Office.

- 3. The Awarding Authority reserves the right to waive technicalities and to reject any or all proposals as provided in BLRS Special Provision for Bidding Requirements and Conditions for Material/Deliver and Install Proposals.
4. A proposal guaranty in the proper amount, as specified in the BLRS Special Provision for Bidding Requirements and Conditions for Material/Deliver and Install Proposals, will be required. See the attached Special Provisions for specific instructions for proposal guaranty for this proposal packet.
5. The successful bidder at the time of execution of the contract will be required to deposit a contract bond or proposal guaranty as provided for in the special provisions. Failure on the part of the contractor to deliver the material within the time specified or to do the work specified herein will be considered just cause to forfeit his surety as provided in Article 108.10 of the Standard Specifications.
6. Proposals shall be submitted on forms furnished by the Awarding Authority and shall be enclosed in an envelope endorsed "Material Proposal, Section 24-00000-00-GM".

By Order of Awarding Authority
Menard County Board of Commissioners

County Engineer/Superintendent of Highways/ Municipal Clerk Date
Corey A. Dowd

Material Proposal or Deliver & Install Proposal

To Awarding Authority
Menard County Board of Commissioners

Awarding Authority Address City State Zip Code
15620 Chautauqua Road Petersburg IL 62675

If this bid is accepted within 45 days from the date of opening, the undersigned agrees to furnish or to deliver & install any or all of the materials, at the quoted unit prices, subject to the following:

- 1. It is understood and agreed that the "Standard Specifications for Road and Bridge Construction", adopted 01/01/22, and the "Supplemental Specifications and Recurring Special Provisions", adopted 01/01/24, prepared by the Department of Transportation, shall govern insofar as they may be applied and insofar as they do not conflict with the special provision and supplemental specifications attached hereto.
2. It is understood that quantities listed are approximate only and that they may be increased or decrease as may be needed to properly complete the improvement within its present limits or extensions thereto, at the unit prices stated and that bids will be compared on the basis of total price bid for each group.
3. Delivery in total or partial shipments as ordered shall be made within the time specified in the special provisions or by the acceptance at the point and in the manner specified in the "Schedule of Prices". If delivery on the job site is specified, it shall mean any place or paces on the road designed by the awarding authority or its authorized representative.
4. The contractor and/or local public agency performing the actual material placement operations shall be responsible for providing work zone traffic control, unless otherwise specified in this proposal. Such devices shall meet the requirements of and be installed in accordance with applicable provisions of the "Illinois Manual on Uniform Traffic Control Devices" and any referenced Illinois Highway Standards.

Local Public Agency

County

Section Number

	Menard	24-00000-00-GM
--	--------	----------------

5. Each pay item should have a unit price and a total price. If no total price is shown or if there is a discrepancy between the product of the unit price multiplied by the quantity, the unit price shall govern. If a unit price is omitted, the total price will be divided by the quantity in order to establish a unit price. A bid will be declared unacceptable if neither a unit price nor a total price is shown.
6. A proposal guaranty in the proper amount, as specified in BLRS Special Provision for Bidding Requirements and Conditions for Contract Proposals, will be required. The proposal guaranty as specified in the special provisions is attached.

If a bid bond is allowed or required, Department form BLR 12230 or a proposal guaranty check, complying with the specifications, made payable to: Menard County Treasurer of Petersburg, Illinois

The amount of the check is _____ (_____).

Attach Cashier's Check or Certified Check Here

In the event that one proposal guaranty check is intended to cover two or more bid proposals, the amount must be equal to the sum of the proposal guaranties which would be required for each individual bid proposal. If the proposal guaranty check is placed in another bid proposal, state below where it may be found.

The proposal guaranty check will be found in the bid proposal for: Section Number _____).

Discounts will be allowed for payment as follows: _____ calendar days _____ calendar days

Discounts will not be considered in determining the low bidder

Bidder

By

Title

Address

City

State

Zip Code



Local Public Agency	County	Section Number
	Menard	24-00000-00-GM

Material Proposal Schedule of Prices

Group No.	Item(s)	Delivery	Unit	Quantity	Unit Price	Total
1	Seal Coat Aggregate Furnished, CA-16 (Crushed)					
	Location: Atterberry "Y"	FOB Stockpile	Ton	1,550		
	Location: County Yard	FOB Stockpile	Ton	1,400		
2	Seal Coat Aggregate Furnished, CA-16 (Gravel)					
	Location: Atterberry "Y"	FOB Source	Ton	50		
3	Seal Coat Aggregate Furnished, CA13 (Crushed)	FOB Stockpile	Ton	1,600		
	Location: County Yard					
4	Aggregate Surface Course Type B CA-6, Low PI	FOB Stockpile	Ton	1,000		
	Location: County Yard					
5	Seal Coat Aggregate Furnished, CA-16 (Crushed)	FOB Source	Ton	500		
6	Aggregate Surface Course Type B CA-6, Low PI	FOB Source	Ton	500		
7	Course Aggregate (CM-2, 2" Crushed)	FOB Source	Ton	500		

The undersigned firm certifies that it has not been convicted of bribery or attempting to bribe an officer or employee of the State of Illinois, nor has the firm made an admission of guilt of such conduct which is a matter of record, nor has an official, agent, or employee of the firm committed bribery or attempted bribery on behalf of the firm and pursuant to the direction or authorization of a responsible official of the firm. The undersigned firm further certifies that it is not barred from contracting with any unit of State or local government as a result of a violation of State laws prohibiting bid-rigging or bid rotating.

Bidder Signature & Date

Address	City	State	Zip Code



11

12

7

16

Petersburg

POP.
2,260

FAP
737

575

8

7

573

12

14

576

18

17

13

TICE
RD

ST
KYS

15

4

Menard County Highway Department
15620 Chautauqua Road
Petersburg, Illinois 62675

Story Br

5

23

24

SUNNY
RD

ACRES
RD

Tice

574

ATHENS
RD

30

BLACKTOP
RD

29

STATE

26

STATE
PARK RD

25

LINCOLN'S
NEW SALEM
HISTORIC
SITE

2

GUS LN

8

Rocky Br

FAP 34

HEDRICK
ST

36 RD

SPRITCHET VILLEG

Sangamon River

32

31

LOCATION MAP

AVE

CHAMBERS
RD

BOY

ERS
ST

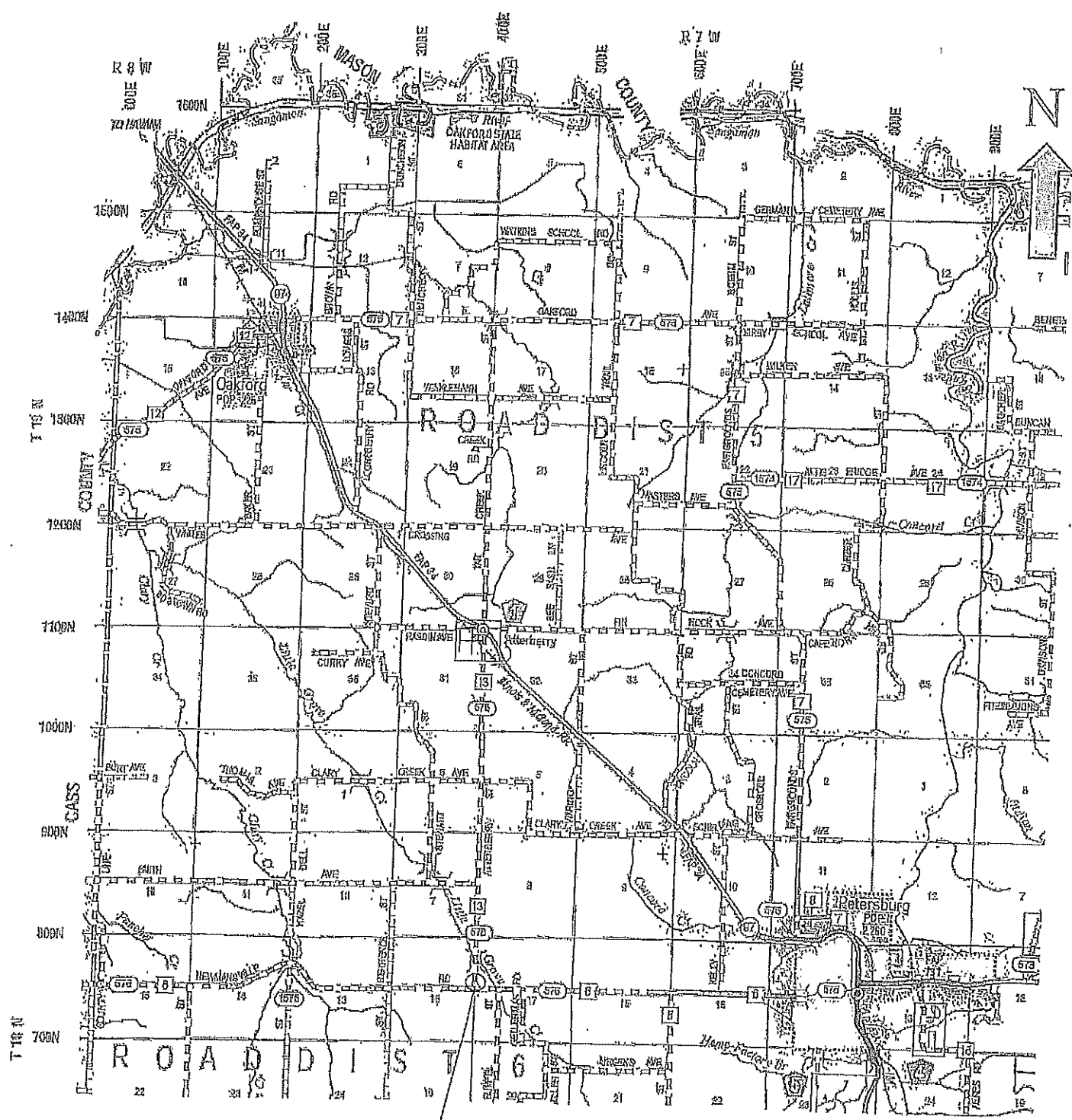

Menard Co. Hwy. Dept.
 Atterberry "Y"
 Stockpile Location Map

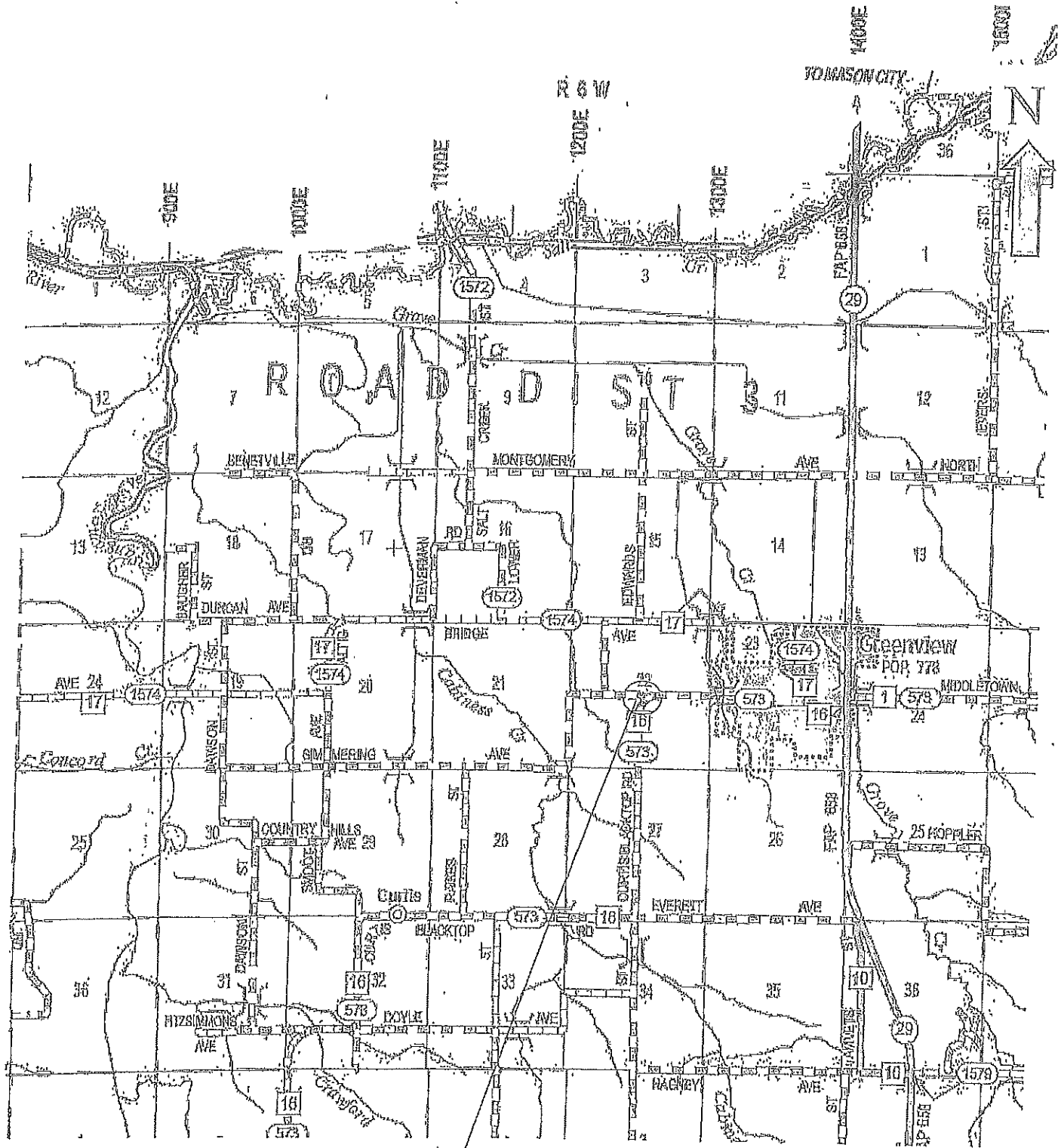

Menard Co. Hwy. Dept.
 "Windmill Corner"
 Stockpile Location Map



Local Public Agency

County

Section Number

	Menard	24-00000-00-GM
--	--------	----------------

Check this box for lettings prior to 01/01/2024.

The Following Recurring Special Provisions Indicated By An "X" Are Applicable To This Contract And Are Included By Reference:

Recurring Special Provisions

<u>Check Sheet #</u>		<u>Page No.</u>
1	<input type="checkbox"/> Additional State Requirements for Federal-Aid Construction Contracts	59
2	<input type="checkbox"/> Subletting of Contracts (Federal-Aid Contracts)	62
3	<input type="checkbox"/> EEO	63
4	<input type="checkbox"/> Specific EEO Responsibilities Non Federal-Aid Contracts	73
5	<input type="checkbox"/> Required Provisions - State Contracts	78
6	<input type="checkbox"/> Asbestos Bearing Pad Removal	84
7	<input type="checkbox"/> Asbestos Waterproofing Membrane and Asbestos HMA Surface Removal	85
8	<input type="checkbox"/> Temporary Stream Crossings and In-Stream Work Pads	86
9	<input type="checkbox"/> Construction Layout Stakes	87
10	<input type="checkbox"/> Use of Geotextile Fabric for Railroad Crossing	90
11	<input type="checkbox"/> Subsealing of Concrete Pavements	92
12	<input type="checkbox"/> Hot-Mix Asphalt Surface Correction	96
13	<input type="checkbox"/> Pavement and Shoulder Resurfacing	98
14	<input type="checkbox"/> Patching with Hot-Mix Asphalt Overlay Removal	99
15	<input type="checkbox"/> Polymer Concrete	101
16	<input type="checkbox"/> Reserved	103
17	<input type="checkbox"/> Bicycle Racks	104
18	<input type="checkbox"/> Temporary Portable Bridge Traffic Signals	106
19	<input type="checkbox"/> Nighttime Inspection of Roadway Lighting	108
20	<input type="checkbox"/> English Substitution of Metric Bolts	109
21	<input type="checkbox"/> Calcium Chloride Accelerator for Portland Cement Concrete	110
22	<input type="checkbox"/> Quality Control of Concrete Mixtures at the Plant	111
23	<input type="checkbox"/> Quality Control/Quality Assurance of Concrete Mixtures	119
24	<input type="checkbox"/> Reserved	135
25	<input type="checkbox"/> Reserved	136
26	<input type="checkbox"/> Temporary Raised Pavement Markers	137
27	<input type="checkbox"/> Restoring Bridge Approach Pavements Using High-Density Foam	138
28	<input type="checkbox"/> Portland Cement Concrete Inlay or Overlay	141
29	<input type="checkbox"/> Portland Cement Concrete Partial Depth Hot-Mix Asphalt Patching	145
30	<input type="checkbox"/> Longitudinal Joint and Crack Patching	148
31	<input type="checkbox"/> Concrete Mix Design - Department Provided	150
32	<input type="checkbox"/> Station Numbers in Pavements or Overlays	151

Local Public Agency	County	Section Number
	Menard	24-00000-00-GM

The Following Local Roads And Streets Recurring Special Provisions Indicated By An "X" Are Applicable To This Contract And Are Included By Reference:

Local Roads And Streets Recurring Special Provisions

<u>Check Sheet #</u>		<u>Page No.</u>
LRS 1	Reserved	153
LRS 2	<input type="checkbox"/> Furnished Excavation	154
LRS 3	<input type="checkbox"/> Work Zone Traffic Control Surveillance	155
LRS 4	<input type="checkbox"/> Flaggers in Work Zones	156
LRS 5	<input checked="" type="checkbox"/> Contract Claims	157
LRS 6	<input type="checkbox"/> Bidding Requirements and Conditions for Contract Proposals	158
LRS 7	<input checked="" type="checkbox"/> Bidding Requirements and Conditions for Material Proposals	164
LRS 8	Reserved	170
LRS 9	<input type="checkbox"/> Bituminous Surface Treatments	171
LRS 10	Reserved	175
LRS 11	<input checked="" type="checkbox"/> Employment Practices	176
LRS 12	<input type="checkbox"/> Wages of Employees on Public Works	178
LRS 13	<input type="checkbox"/> Selection of Labor	180
LRS 14	<input type="checkbox"/> Paving Brick and Concrete Paver Pavements and Sidewalks	181
LRS 15	<input type="checkbox"/> Partial Payments	184
LRS 16	<input type="checkbox"/> Protests on Local Lettings	185
LRS 17	<input type="checkbox"/> Substance Abuse Prevention Program	186
LRS 18	<input type="checkbox"/> Multigrade Cold Mix Asphalt	187
LRS 19	<input type="checkbox"/> Reflective Crack Control Treatment	188



Local Public Agency	County	Section Number
	Menard	24-00000-00-GM

The following Special Provision supplement the "Standard Specifications for Road and Bridge Construction", adopted January 1, 2022, the latest edition of the "Manual on Uniform Traffic Control Devices for Streets and Highways", and the "Manual of Test Procedures of Materials" in effect on the date of invitation of bids, and the Supplemental Specification and Recurring Special Provisions indicated on the Check Sheet included here in which apply to and govern the construction of the above named section, and in case of conflict with any parts, or parts of said Specifications, the said Special Provisions shall take precedence and shall govern.

NOTICE TO ALL BIDDERS:

Please mark the outside of the bid envelopes "2024 General Aggregates Letting, Menard County".

The materials to be purchased as a result of this letting are for the use of Menard County to accomplish their 2024 construction and maintenance programs. Pre-qualification of bidders shall NOT apply to this proposal.

A BID BOND will NOT be accepted for the proposal guaranty.

The bidder has to option of bidding any or all of the groups. The award will be made to the lowest responsible bidder for each group. The bidder may submit one proposal guaranty covering the total of the entire groups bid rather than a proposal guaranty for each group bid.

The successful bidder shall have the option of substituting a surety bond for the full amount of the award for his proposal guaranty or reducing the proposal guaranty to cover all those groups for which the bidder was low bidder.

All, part, or none of any group may be purchased. The County reserves the right to increase or decrease the quantity of materials. No allowance will be made in the unit price bid for any increase or decrease in quantities. The unit prices bid shall remain firm until December 31, 2024.

For the purpose of determining the low bidder, 15 cents per ton mile shall be used as a hauling differential. Mileage shall be from the source to the Menard County Highway Department stockpile.

DISTRICT 6 – LOCAL ROADS & STREETS
 SPECIAL PROVISIONS FOR
 PROPOSAL GUARANTY and
 SUPPLIERS COMMITMENT
 Effective April 1, 2016

STANDARD SPECIFICATIONS:

All references to Sections or Articles in these specifications shall be construed to mean a specific Section or Article of the Standard Specifications for Road and Bridge Construction, adopted by the Illinois Department of Transportation on April 1, 2016.

(Please Mark All Applicable Check Boxes)

PROPOSAL GUARANTY

All sections of either Check Sheet LRS 6 or LRS 7 of the "Supplemental Specifications and Recurring Special Provisions" remain in full force, except the section on the Proposal Guaranty.

A certified check, bank cashier's check (both hereafter called "check") or bank draft for the percentage of the amount of the bid, or for the amount specified in the following schedules, shall be submitted with all proposals. After award has been made, arrangements may be made to substitute a "check" or bank draft for the percentage of the amount of the award, or for the amount specified in the following schedule.

A bid bond will be allowed / will not be allowed.

Amount of Bid		<input checked="" type="checkbox"/> 5% or <input checked="" type="checkbox"/> Proposal Guaranty	<input type="checkbox"/> 10% or <input type="checkbox"/> Proposal Guaranty
	Up to 5,000	\$150	\$ 300
\$ 5,000	10,000	300	500
10,000	50,000	1,000	2,500
50,000	100,000	3,000	5,000
100,000	150,000	5,000	7,500
150,000	250,000	7,500	12,500
250,000	500,000	12,500	25,000
500,000	1,000,000	25,000	50,000
1,000,000	1,500,000	50,000	75,000
1,500,000	2,000,000	100,000	100,000
2,000,000	3,000,000	150,000	150,000
3,000,000	5,000,000	200,000	200,000
5,000,000	7,500,000	300,000	300,000
7,500,000	10,000,000	400,000	400,000
10,000,000	15,000,000	500,000	500,000
15,000,000	20,000,000	600,000	600,000
20,000,000	25,000,000	700,000	700,000
25,000,000	30,000,000	800,000	800,000
30,000,000	35,000,000	900,000	900,000
over	35,000,000	1,000,000	1,000,000

All "checks" and bank drafts shall be made payable to the Menard County Treasurer. The unsuccessful bidder(s) "checks" or bank drafts shall be returned at the time of the award.

The successful bidder(s) "check" or bank draft shall be held to insure prompt and faithful performance of the provisions of this agreement. The same shall be returned to the successful bidder(s) after satisfactory delivery of the materials has been made.

Failure on the part of the successful bidder(s) to make satisfactory delivery of the materials within 10 days from the date of the notice to ship the materials will be considered as just cause for the forfeiture of the "check" or bank draft to the Menard County Treasurer.

The successful bidder(s) may substitute a surety bond for the full amount of the award in lieu of the proposal guarantee after award and with the approval of the Menard County Board of Commissioners.

TERMINATION OF CONTRACT:

It is understood that this agreement shall terminate on December 31, 2024.

SUPPLIERS COMMITMENT

Any bidder who does not furnish the Bituminous Materials or Seal Coat Aggregate from their own plant or quarry shall supply a commitment from a supplier that will furnish that material to the bidder. The commitment is for quantity of material only---price is between the bidder and the supplier. The quantity of material covered in the commitment shall be the quantity bid for each type of material plus 50% for possible overrun. This commitment is to be submitted with the bid. NO BID WILL BE READ IF IT IS NOT ENCLOSED.

DISTRICT 6 – LOCAL ROADS & STREETS
SPECIAL PROVISIONS FOR
SEAL COAT AGGREGATE (CA XX)
PRE-COAT SEAL COAT AGGREGATE (CA XX)
Effective January 1, 2022

STANDARD SPECIFICATIONS:

All references to Sections or Articles in these specifications shall be construed to mean a specific Section or Article of the Standard Specifications for Road and Bridge Construction, adopted by the Illinois Department of Transportation on January 1, 2022.

MATERIAL:

All materials shall conform to Section 1004 and 1032. The producer may substitute approved CM xx; instead of the CA xx as part of the "Aggregate Gradation Control System" (AGCS).

EQUIPMENT:

All equipment shall be in first class condition and shall be of an approved type. Unless otherwise specified, the following equipment shall be used and shall meet the following requirements:

The aggregate shall be spread by means of an aggregate spreader conforming to Article 1102.04.

The mechanical sweeper shall conform to Article 1101.03.

The roller shall conform to Article 1101.01 (a) Pneumatic-Tired Rollers or (c) Self Propelled Pneumatic-Tired Rollers.

(Please Mark All Applicable Check Boxes)

CONSTRUCTION METHODS:

The methods used in performing the work shall be as follows:

Immediately after the bituminous material has been applied, aggregate shall be spread over the treated surface at the rate of ____ to ____ pounds per square yard.

The contractor will / will not be required to provide sweeping as specified in Section 403.

The contractor will / will not be required to provide rolling as specified in Section 403.

SEAL COAT AGGREGATE (CA XX)

- CA 13
- CA 14
- CA 15
- CA 16

MATERIAL:

The aggregate for the surface treatment shall consist of clean, hard, durable particles of gravel or crushed stone substantially free from foreign material, and when a representative sample is tested with laboratory sieves, it shall conform to the above gradation(s).

The quality shall be Class C or better / Class D or better.

When D quality is specified, the percent passing the #200 sieve shall be 0-4.0%, AASHTO T 11 (IL modified)

BASIS OF PAYMENT:

The work shall be paid for at the contract unit price per ton for **SEAL COAT AGGREGATE (CA XX)**, which price shall be payment in full for furnishing all materials either **FOB Trucks at Source** or **Stockpile** or **Delivered & Installed** as indicated on BLR 12241 "Material Proposal Schedule of Prices". The price for **Delivered & Installed** shall include the cost of sweeping and rolling, if required and no additional compensation will be given.

PRE-COAT SEAL COAT AGGREGATE (CA XX)

DESCRIPTION:

This work shall consist of mixing asphalt and an approved aggregate in a hot mix plant or a pug mill.

MATERIALS:

The aggregate gradation shall be CA 13 CA 14 CA 15 CA 16.

The quality shall be Class C or better / Class D or better.

When D quality is specified, the percent passing the #200 sieve shall be 0-4.0%, AASHTO T 11 (IL modified)

The bituminous material shall be PG46-28 PG52-28 PG58-28
 SS-1 CSS-1 SC-70 HFE-150.

EQUIPMENT:

The hot mix plant or pug mill shall meet the requirements of Article 1102. The pug mill shall be a twin shaft mixer equipped with aggregate and asphalt measuring devices and approved by the Engineer.

GENERAL:

The bituminous material and the aggregate shall be mixed until all aggregate is uniformly coated without excess. The amount of asphalt will vary according to porosity and amount of dust, but in

no case shall it be less than ½% or more than 1-½% residual asphalt by weight of aggregate. The same gradation of aggregate and grade of bituminous materials shall be used throughout all work involving pre-coated aggregate.

It shall be the responsibility of the Contractor to provide a sample of the pre-coated material to the District 6 Materials in Springfield or Quincy for determination of the asphalt content.

BASIS OF PAYMENT:

The work shall be paid for at the contract unit price per ton for **SEAL COAT AGGREGATE (PRE-COAT) (CA XX)**, which price shall be payment in full for furnishing all materials either **FOB Trucks at Source** or **Stockpile** or **Delivered & Installed** as indicated on BLR 12241 "Material Proposal Schedule of Prices". The price for **Delivered & Installed** shall include the cost of sweeping and rolling, if required and no additional compensation will be given.

-
- SEAL COAT AGGREGATE (CA XX)
 - COURSE AGGREGATE FOR BITUMINOUS COURSE, CLASS A

The aggregate for the surface treatment shall consist of clean, hard, durable particles of gravel or crushed stone substantially free from foreign material and shall conform to Article 1004.04. The aggregate shall be tested to Article 1004.01(b) and meet the following quality requirements:

- The quality shall be Class D or better or
- The quality shall be less than Class D meeting the following:
 1. The maximum allowable Sodium Sulfate Soundness Loss is 30%.
 2. The maximum allowable L.A. Abrasion Loss is 60%.
 3. Revise the gradation table of Article 1004.03(c) to include CM 15 for seal coat use in Class A-1

The percent passing the #200 sieve shall be 0-4.0%, AASHTO T 11 (IL modified)

BASIS OF PAYMENT:

The work shall be paid for at the contract unit price per ton for:

- CA 13
- CA 14
- CA 15
- CA 16

which price shall be payment in full for furnishing all materials either **FOB Trucks at Source** or **Stockpile** or **Delivered & Installed** as indicated on BLR 12241 "Material Proposal Schedule of Prices". If this material is to be delivered from more than one location, the exact location of each delivery point shall be clearly indicated in the space provided.

DISTRICT 6 – LOCAL ROADS & STREETS
SPECIAL PROVISIONS FOR
ROCKFILL (PRIMARY CRUSHER RUN),
RIPRAP 1,
COARSE AGGREGATE, 3" (CA 1),
AGGREGATE BASE REPAIR (CA 3),
AGGREGATE (CA 6),
AGGREGATE SURFACE COURSE (CA 7),
AGGREGATE SURFACE COURSE (CA 8) and
AGGREGATE SURFACE COURSE (FURNISHED) (CA xx)
Effective January 1, 2022

STANDARD SPECIFICATIONS:

All references to Sections or Articles in these specifications shall be construed to mean a specific Section or Article of the Standard Specifications for Road and Bridge Construction, adopted by the Illinois Department of Transportation on January 1, 2022.

MATERIAL:

All materials shall conform to Section 1004 and 1005. The producer may substitute approved CM xx; instead of the CA xx as part of the "Aggregate Gradation Control System" (AGCS).

(Please Mark All Applicable Check Boxes)

ROCKFILL (PRIMARY CRUSHER RUN)

Primary Crusher Run shall be the end result of the material produced through the primary crusher. The material shall be produced in such a manner to produce a well-graded product with sufficient fines and small particles to fill the voids when in place. *(Note for Designer: This Rockfill specification has a higher quality requirement than Article 1005.01(b)(2).)*

Rockfill shall be quarried from a ledge approved for Class B Quality riprap.

BASIS OF PAYMENT:

This work shall be paid for at the unit price per ton for **ROCKFILL (PRIMARY CRUSHER RUN)**, which price shall be payment in full for furnishing all materials either **FOB Trucks at Source** or **Stockpile** as indicated on BLR 12241 "Material Proposal Schedule of Prices".

RIPRAP RR1

The quality shall be Class B or better.

BASIS OF PAYMENT:

This work shall be paid for at the unit price per ton for **RIPRAP RR1**, which price shall be payment in full for furnishing all materials either **FOB Trucks at Source** or **Stockpile** as indicated on BLR 12241 "Material Proposal Schedule of Prices".

COARSE AGGREGATE, 3" (CA 1)

The quality shall be Class C or better / Class D or better.

BASIS OF PAYMENT:

This work shall be paid for at the unit price per ton for **COARSE AGGREGATE, 3" (CA 1)**, which price shall be payment in full for furnishing all materials either **FOB Trucks at Source** or **Stockpile** as indicated on BLR 12241 "Material Proposal Schedule of Prices".

AGGREGATE BASE REPAIR (CA 3)

The quality shall be Class C or better / Class D or better.

BASIS OF PAYMENT:

This work shall be paid for at the unit price per ton for **AGGREGATE BASE REPAIR (CA 3)**, which price shall be payment in full for furnishing all materials either **FOB Trucks at Source** or **Stockpile** as indicated on BLR 12241 "Material Proposal Schedule of Prices".

AGGREGATE (CA 6)

The computation of quantities for CA 6 is based on the use of limestone in order to produce a certain volume of material. Slags and other materials meeting the specifications for CA 6 may have appreciably different specific gravities, thereby significantly altering the desired volume.

Therefore, if materials other than limestone are to be provided, a comparison of bid prices will be made. The low bid will be determined by multiplying the unit bid price by the ratio of the specific gravity of the non-limestone material to that of limestone.

Specific gravities of the materials known to meet the CA 6 specifications which will be used in the aforementioned computation are:

Limestone	2.67
Air Cooled Blast Furnace Slag	2.30
Copper Slag	3.60
Gravel	2.52

The quality shall be Class D or better.

BASIS OF PAYMENT:

This work shall be paid for at the unit price per ton for **AGGREGATE (CA 6)**, which price shall be payment in full for furnishing all materials either **FOB Trucks at Source** or **Stockpile** as indicated on BLR 12241 "Material Proposal Schedule of Prices".

AGGREGATE SURFACE COURSE (CA 7)

The quality shall be Class C or better / Class D or better.

BASIS OF PAYMENT:

The work shall be paid for at the unit price per ton for **AGGREGATE SURFACE COURSE TYPE B, (CA 7)**, which price shall be payment in full for furnishing all materials either **FOB Trucks at Source** or **Stockpile** as indicated on BLR 12241 "Material Proposal Schedule of Prices".

AGGREGATE SURFACE COURSE (CA 8)

The plasticity index will / will not apply.

The quality shall be Class D or better.

BASIS OF PAYMENT:

This work shall be paid for at the contract unit price per ton for **AGGREGATE SURFACE COURSE TYPE B, (CA 8)**, which price shall be payment in full for furnishing all materials either **FOB Trucks at Source** or **Stockpile** as indicated on BLR 12241 "Material Proposal Schedule of Prices".

AGGREGATE SURFACE COURSE (FURNISHED), (CA xx)

The aggregate for the surface treatment shall consist of clean, hard, durable particles of gravel or crushed stone substantially free from foreign material. The aggregate shall be tested to Article 1004.01(b) and meet the following quality requirements:

The quality shall be Class D or better or

The quality shall be less than Class D meeting the following:

1. The maximum allowable Sodium Sulfate Soundness Loss is 40%.
2. The maximum allowable L.A. Abrasion Loss is 50%.
3. The sum of the percentage of Sodium Sulfate Soundness Loss and the L.A. Abrasion Loss, shall not exceed 80%.

BASIS OF PAYMENT:

The work shall be paid for at the contract unit price per ton for:

- AGGREGATE SURFACE COURSE (FURNISHED), (CA 6)**
- AGGREGATE SURFACE COURSE (FURNISHED), (CA 7)**
- AGGREGATE SURFACE COURSE (FURNISHED), (CA 8)**
- AGGREGATE SURFACE COURSE (FURNISHED), (CA 9)**
- AGGREGATE SURFACE COURSE (FURNISHED), (CA 10)**

which price shall be payment in full for furnishing all materials either **FOB Trucks at Source** or **Stockpile** as indicated on BLR 12241 "Material Proposal Schedule of Prices".

-
- AGGREGATE SURFACE COURSE (FURNISHED), (CA xx)
 - BASE COURSE
 - SHOULDER AGGREGATE

The aggregate for the surface treatment shall consist of clean, hard, durable particles of gravel or crushed stone substantially free from foreign material. The quality shall be Class D or better. The aggregate shall be tested to Article 1004.04 and meet the following quality requirements:

- The quality shall be Class D or better or
- The quality shall be less than Class D meeting the following:
 1. The maximum allowable Sodium Sulfate Soundness Loss is 40%.
 2. The maximum allowable L.A. Abrasion Loss is 50%.
 3. The sum of the percentage of Sodium Sulfate Soundness Loss and the L.A. Abrasion Loss, shall not exceed 80%.

BASIS OF PAYMENT:

The work shall be paid for at the contract unit price per ton for:

- AGGREGATE SURFACE COURSE (FURNISHED), (CA xx)
- BASE COURSE
- SHOULDER AGGREGATE

which price shall be payment in full for furnishing all materials either **FOB Trucks at Source** or **Stockpile** as indicated on BLR 12241 "Material Proposal Schedule of Prices".

State of Illinois
Department of Transportation
Bureau of Local Roads and Streets

SPECIAL PROVISION
FOR
INSURANCE

Effective: February 1, 2007
Revised: August 1, 2007

All references to Sections or Articles in this specification shall be construed to mean specific Section or Article of the Standard Specifications for Road and Bridge Construction, adopted by the Department of Transportation.

The Contractor shall name the following entities as additional insured under the Contractor's general liability insurance policy in accordance with Article 107.27:

Menard County Highway Department

The entities listed above and their officers, employees, and agents shall be indemnified and held harmless in accordance with Article 107.26.



Local Public Agency	County	Section Number
Menard County Highway	Menard	24-00000-00-GM

Information Required Prior to Advertisement

PS & E Approval Date	ROW Status	11 Day Requirement Fulfilled?	21 Day Federal Requirement Fulfilled?
	N/A	<input checked="" type="checkbox"/> Yes <input type="checkbox"/> N/A	<input type="checkbox"/> Yes <input checked="" type="checkbox"/> N/A

Dates to be advertised	<input checked="" type="checkbox"/> 3 weeks-non-federal project
1/29/24, 2/5/24, & 2/12/24	

Letting Information

Letting Date	Letting Time	Letting Location
02/22/24	10:00 AM	Menard County Highway Department, 15620 Chautauqua Rd, Petersburg, IL 62675

Project Information

<input type="checkbox"/> Pre-qualification Required	<input type="checkbox"/> Township Bridge	<input checked="" type="checkbox"/> MFT	<input type="checkbox"/> Non-MFT
<input type="checkbox"/> Apprenticeship and Training Certification	<input type="checkbox"/> Federal Funds	<input type="checkbox"/> Re-Advertisement	

Project Description

2950 Ton - Seal Coat Aggregate CA-16 (Crushed) - FOB Stockpile 50 Ton - Seal Coat Aggregate CA-16 (Gravel) - FOB Source 1600 Ton - Seal Coat Aggregate CA-13 (Crushed) - FOB Stockpile 1000 Ton - Aggregate Surface Course Type B CA-6, Low PI - FOB Stockpile 500 Ton - Seal Coat Aggregate CA-16 (Crushed) - FOB Source 500 Ton - Aggregate Surface Course Type B CA-6, Low PI - FOB Source 500 Ton - Course Aggregate CM-2, 2" (Crushed) - FOB Source
--

Project Location

--

Proposal Information

Proposals Available at
Menard County Highway Department

Address	City	State	Zip Code
15620 Chautauqua Road	Petersburg	IL	62675

Phone	Email	Proposal Fee
(217) 632-2722	menardhwy1@sbcglobal.net	

Additional Information

Available Online: menardcountyil.gov

Prepared by	Date
Corey A. Dowd	12/18/23

Phone	Email
(217) 632-2722	menardhwy1@sbcglobal.net